

NATIONAL
CONVENTION
CENTRE **Canberra**

FLOOR PLANS

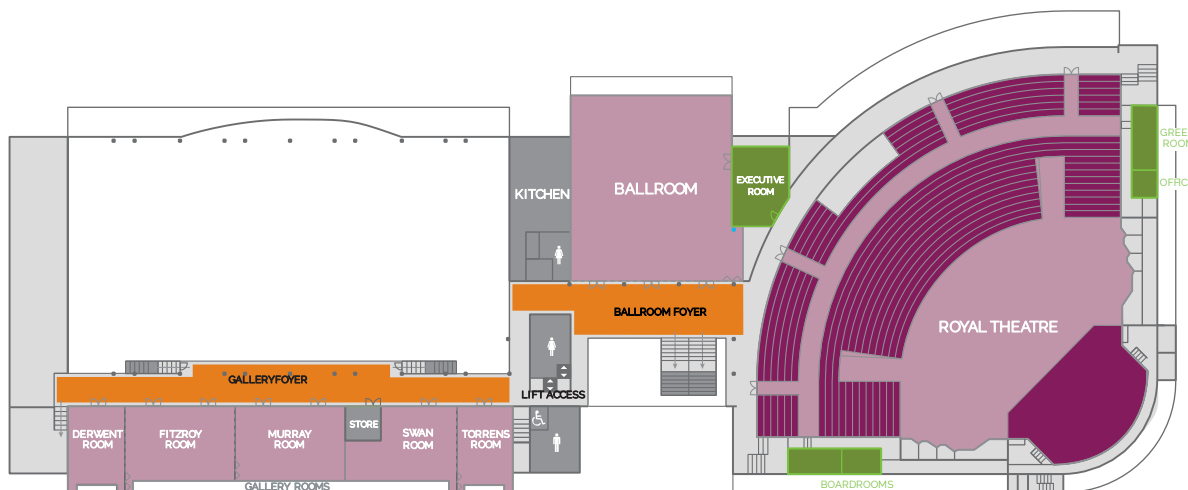

FIRST FLOOR

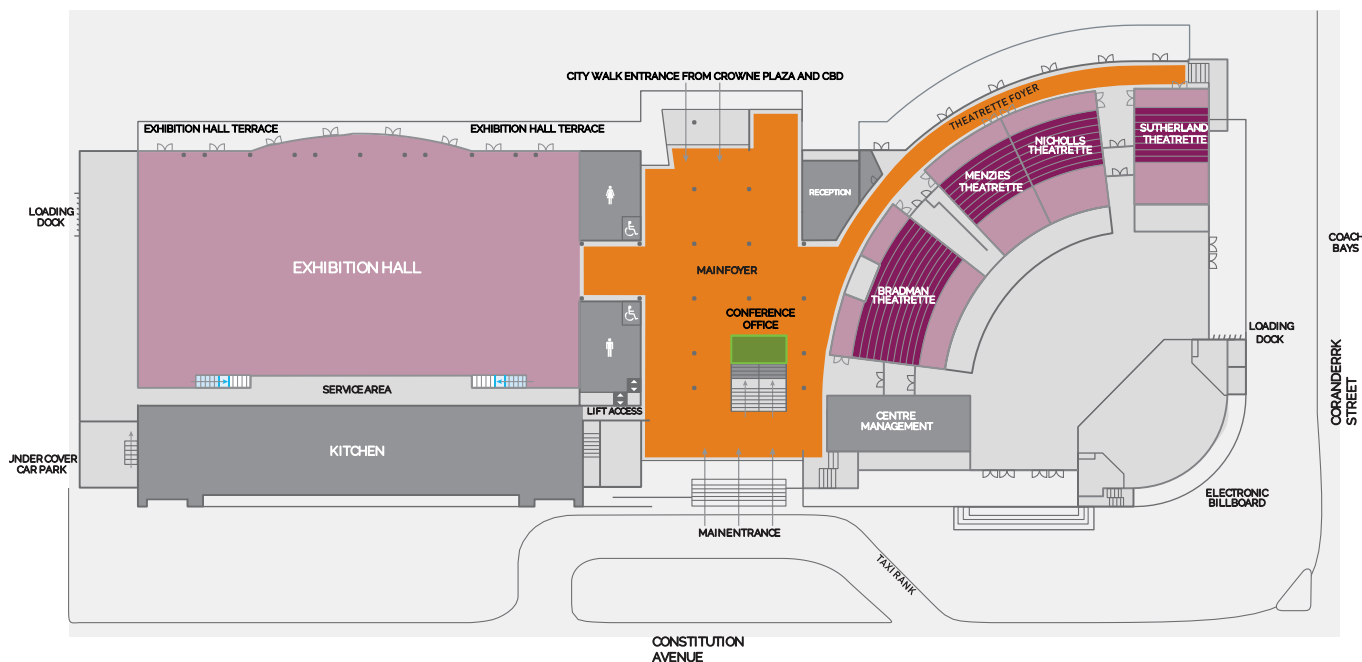

GROUND FLOOR

KEY	MEETING & EXHIBITION SPACES	WORK ROOMS	FACILITIES	FOYERS
-----	-----------------------------	------------	------------	--------

The National Convention Centre Canberra is the perfect events venue, boasting premium facilities for every occasion.

Contact our events team on (02) 6276 5200 or visit us online at nccc.com.au

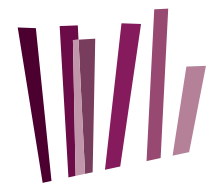

ROOM CAPACITIES

Room	Area (m ²)	Ceiling Height (m)	Booths (3x3m)	Theatre	Cocktails	Banquet	Dinner Dance	Cabaret	Classroom	Boardroom	U Shape	Hollow Square
Exhibition Hall												
Exhibition Hall (Total)	2000	9.0	120	2000	2000	1500	1400	1200	1000	—	—	—
Royal Theatre												
Royal Theatre (Total)	—	9.1	—	2460	—	—	—	—	—	—	—	—
Royal Theatre (Tiered)	—	4.6 - 9.1	—	1710	—	—	—	—	—	—	—	—
Royal Theatre (Flat floor)	749	9.1	—	750	750	540	470	432	400	—	—	—
Theatrettes												
Bradman	360	3.2 - 4.4	—	300	—	—	—	—	—	—	—	—
Menzies	180	3.2 - 4.4	—	165	—	—	—	—	—	—	—	—
Nicholls	180	3.2 - 4.4	—	165	—	—	—	—	—	—	—	—
Sutherland	170	3.2 - 4.4	—	135	—	—	—	—	—	—	—	—
Flat Floor Function Rooms												
Ballroom (Closed)	658	4.5	30	500	500	500	440	360	370	—	96	108
Ballroom (Open)	762	4.5	30	—	650	580	520	—	—	—	—	—
Gallery Rooms (Individual)												
Torrens Room (T)	90	3.3	5	80	80	60	—	48	36	24	30	36
Swan Room (S)	155	3.3	10	140	140	80	80	64	48	36	30	36
Murray (M)	170	3.3	10	170	170	120	100	96	72	42	48	60
Fitzroy (F)	170	3.3	10	170	170	120	100	96	72	42	48	60
Derwent Room (D)	95	3.3	5	80	80	60	—	48	36	24	30	36
Gallery Rooms (Combined)												
TS Rooms	245	3.3	15	200	200	150	130	120	96	48	54	66
MF Rooms	340	3.3	20	368	368	240	210	192	156	—	84	104
FD Rooms	265	3.3	15	256	256	180	150	144	120	—	72	88
MFD Rooms	435	3.3	25	—	512	330	270	—	—	—	—	—
Work Rooms												
Boardroom 1	27	2.6	—	20	—	—	—	—	—	12	—	—
Boardroom 2	24	2.6	—	20	—	—	—	—	—	12	—	—
Green Room	37	2.6	—	30	—	—	—	—	—	20	—	—
Executive Room	90	2.7	—	60	60	50	—	32	40	24	25	30
Foyer Areas												
Main Foyer	1100	3.4	—	—	1000	—	—	—	—	—	—	—
Theatrette Foyer	400	3.8	—	—	200	—	—	—	—	—	—	—
Ballroom Foyer	300	5.3	—	—	200	—	—	—	—	—	—	—
Gallery Foyer	390	4.1	—	—	250	—	—	—	—	—	—	—